



Manufacturer of PCB Terminal Blocks, Fuse Holders, Barrier Terminals, & Switches

Screw Type (Cage-Clamp Design) Connectors

Series 50

(Model : 50/2, 50/3)

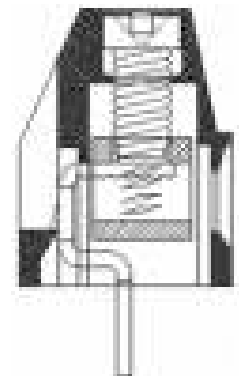
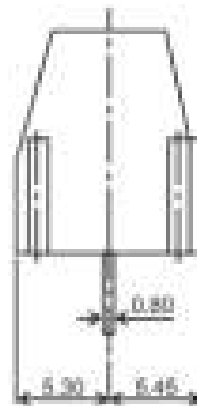
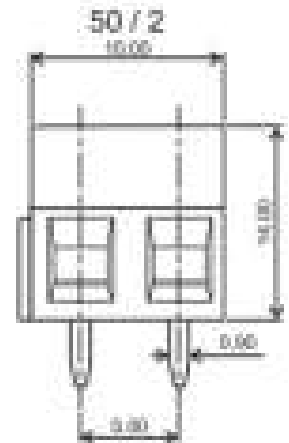
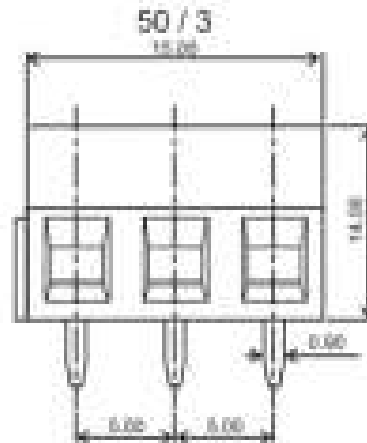

TECHNICAL SPECIFICATIONS :

| | |
|-----------------------|---|
| Pitch | : 5.00 mm |
| Nominal Rating | : 15A/300V |
| Dielectric Strength | : > 2kV |
| Moulded Material | : PA66 - UL94 V0 or V2 |
| Insulation Resistance | : > 1000 M Ω @ 500 Vdc |
| Terminal | : Tin Plated Copper Alloy |
| Wire Cage | : Nickel Plated Brass |
| Screw | : M3 x 0.50 mm : Brass Nickel Plated Suffix "P" : M5 Trivalent Zinc Plated Suffix "C" |
| Wire Size | : 2-5 mm ² |
| Maximum Torque | : 0.30 - 0.40 Nm |

ORDERING CODE

| Series | Poles | Grade |
|--------|-------|-------|
|--------|-------|-------|

→ 50/2 P ←

Number of Poles: 2 or 3

Grade : P or C

P = Professional Grade

C = Economy Grade

Approval Data

UL : 300V / 12A / 26-14 AWG

cUL : 300V / 12A / 26-14 AWG

CE : 300V / 15A / 26-14 AWG